

Plan PB-61-1V _ Ind1 : Bâti bois - Pose scellée

Gamme Porte EI30 Acoustique

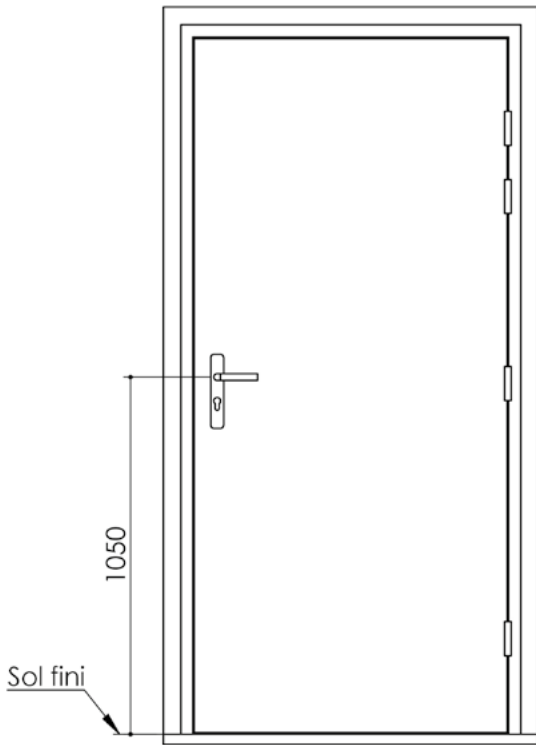

Variante d'étanchéité

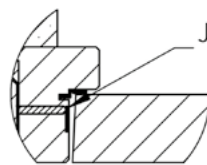

Étanchéité EI30
Joint intumescent
fourni posé
sur l'huisserie

Huisserie isophonique

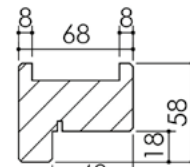

Standard

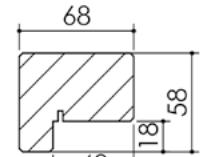

Bâti

Variantes bas de porte

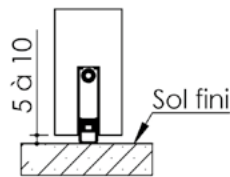

Plinthe automatique

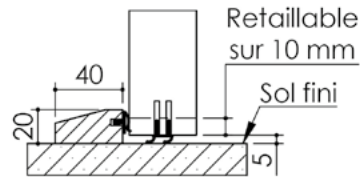

Seuil à la suisse
+ joint balai

3 pattes de fixation
par montant
(non fournies)

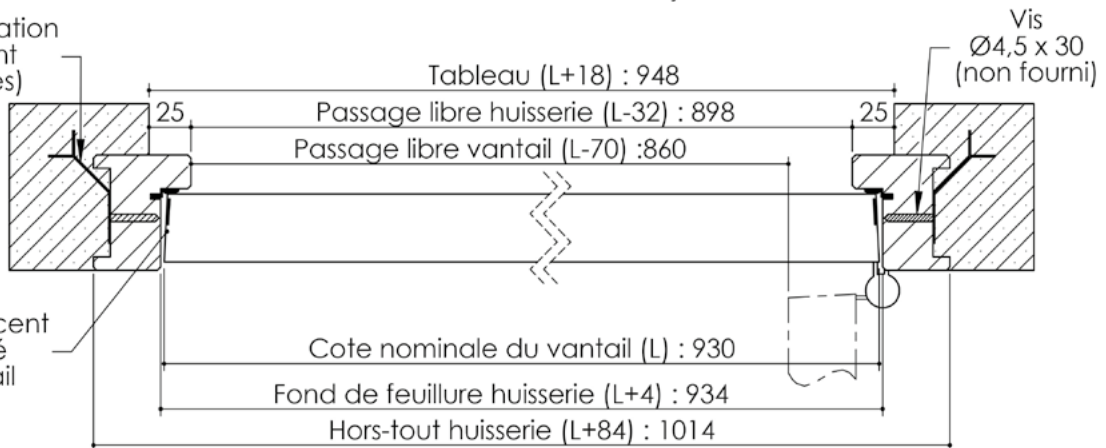

Joint intumescent
fourni posé
sur le vantail