

Vue intérieure

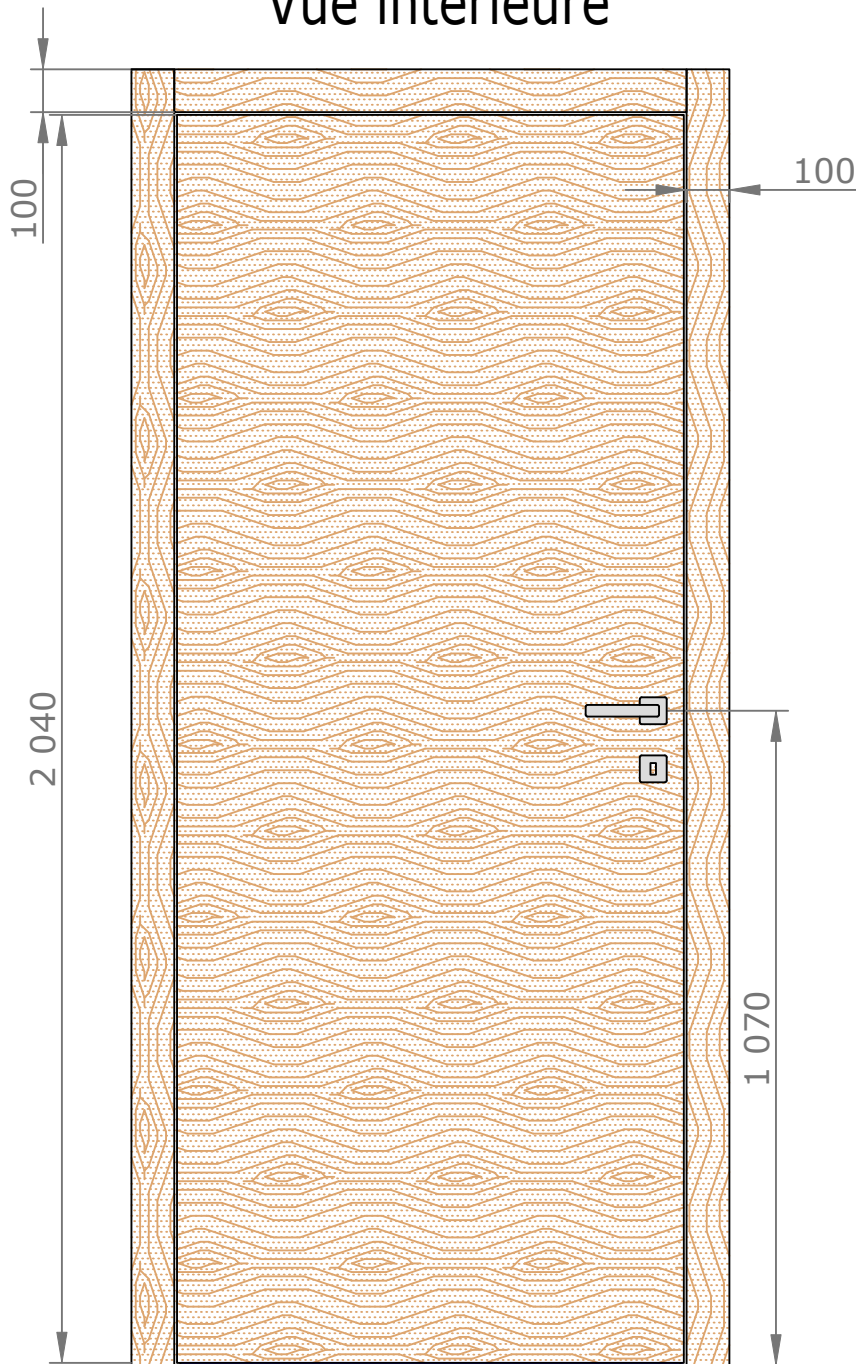

Section verticale

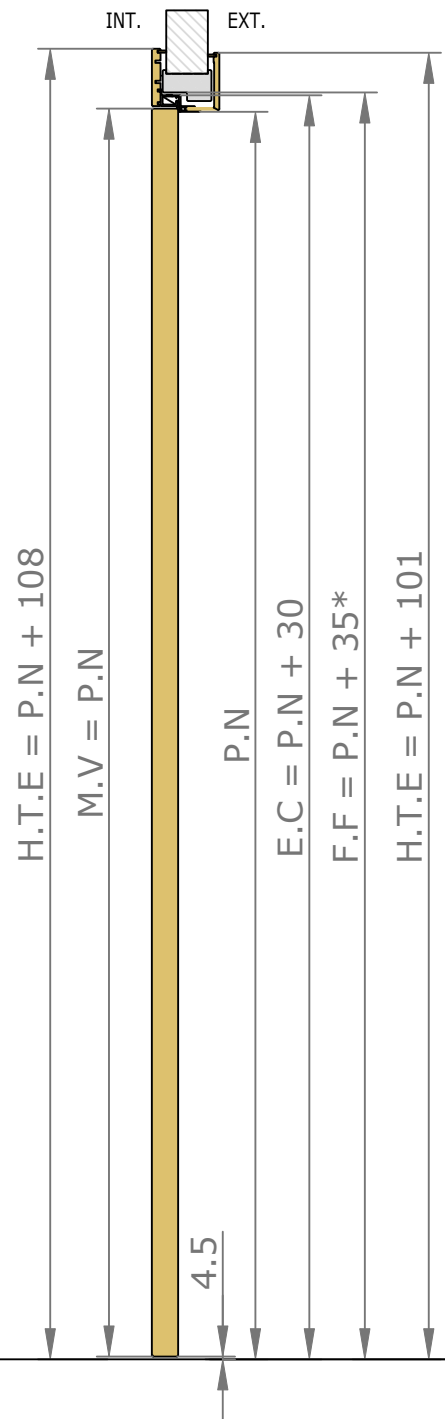

Section horizontale

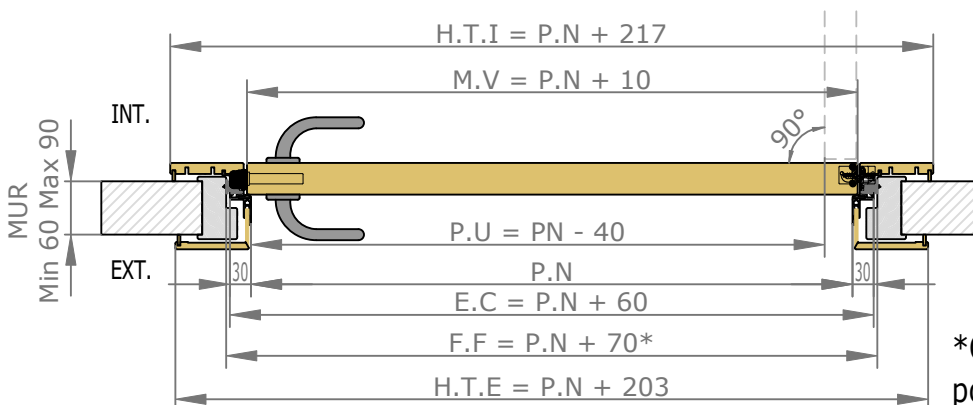

Légende :

- H.T.I = Hors Tout Intérieure
- M.V = Mesure Vantail
- P.U = Passage Utile
- P.N = Passage Nominal
- E.C = Extérieure Cadre
- F.F = Fond de Feuillure
- H.T.E = Hors Tout Extérieure

*Cote à communiquer pour la commande

Vue extérieure

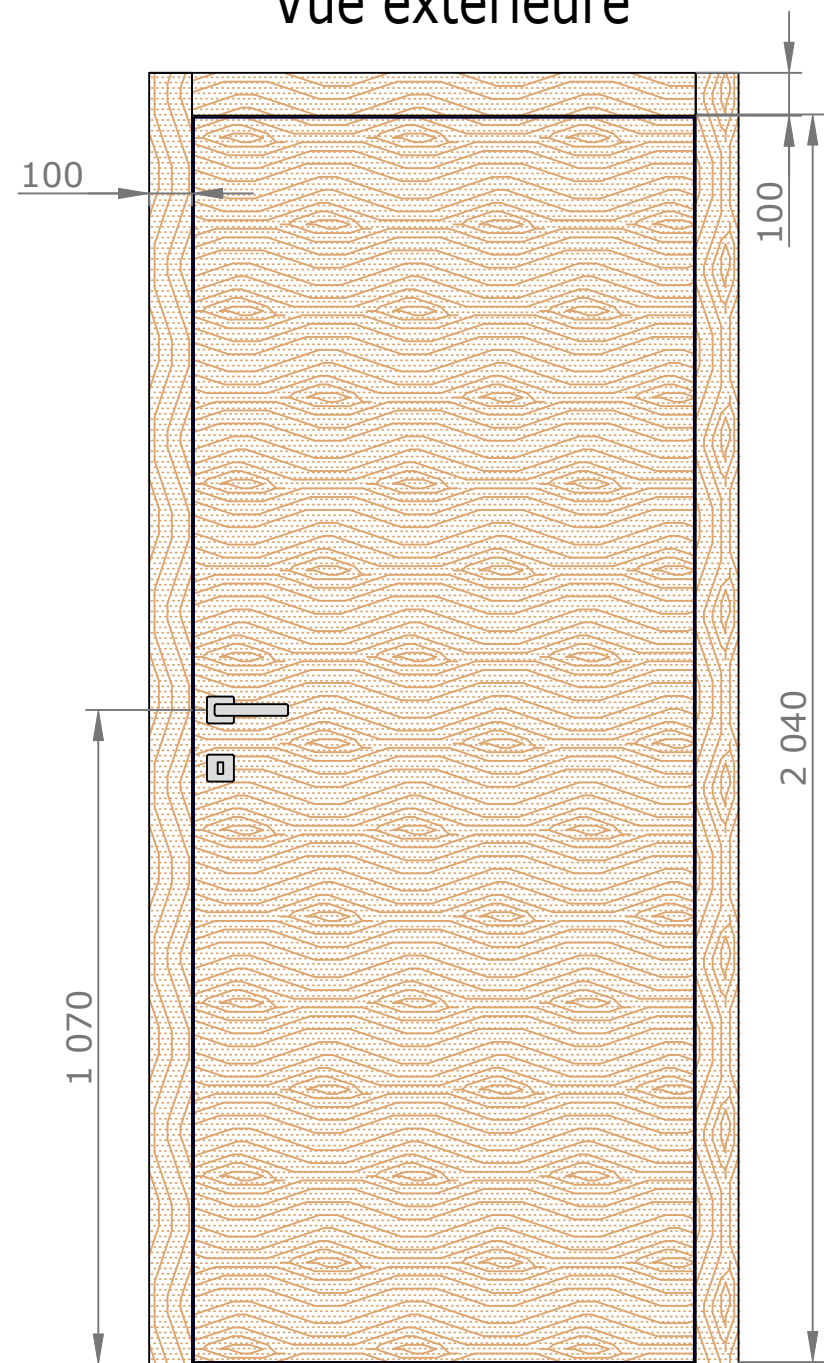

Section verticale

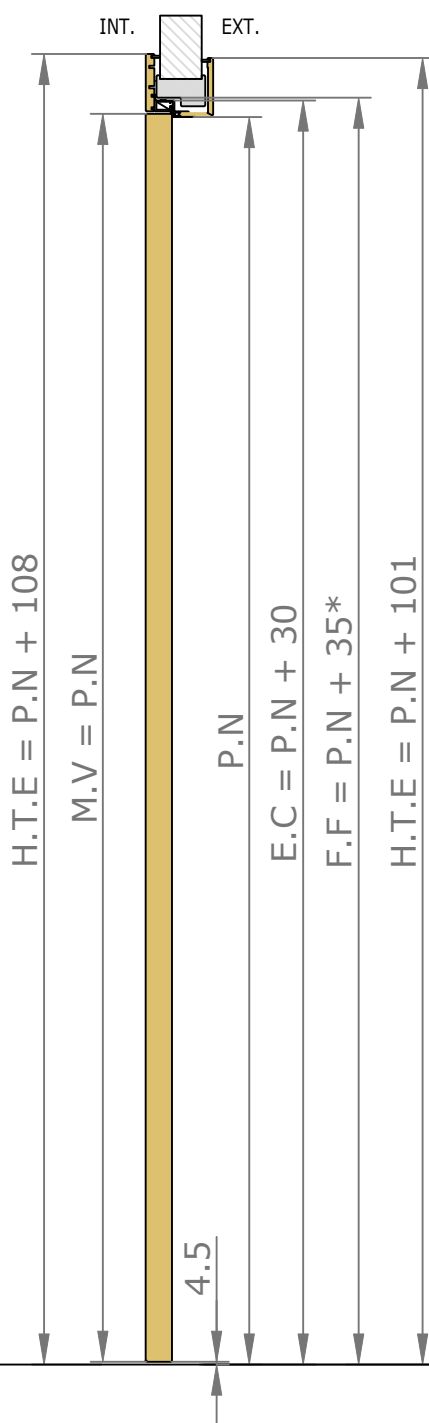

Section horizontale

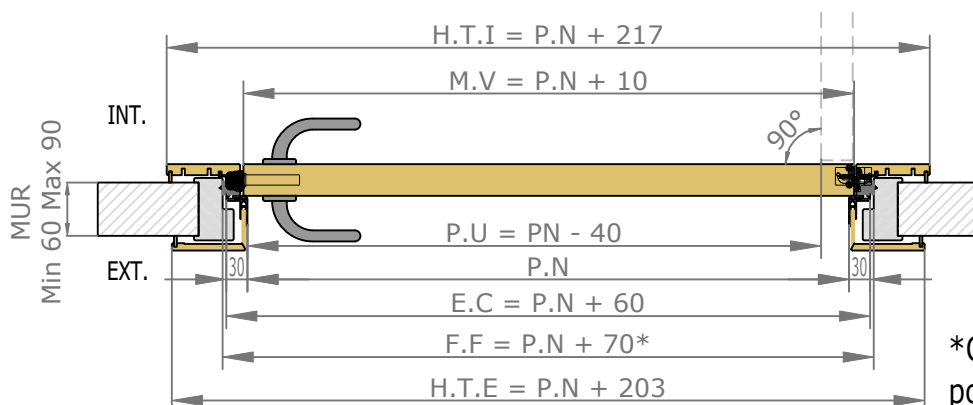

Légende :

- H.T.I = Hors Tout Intérieure
- M.V = Mesure Vantail
- P.U = Passage Utile
- P.N = Passage Nominal
- E.C = Extérieure Cadre
- F.F = Fond de Feuillure
- H.T.E = Hors Tout Extérieure

*Cote à communiquer
pour la commande

Détails techniques

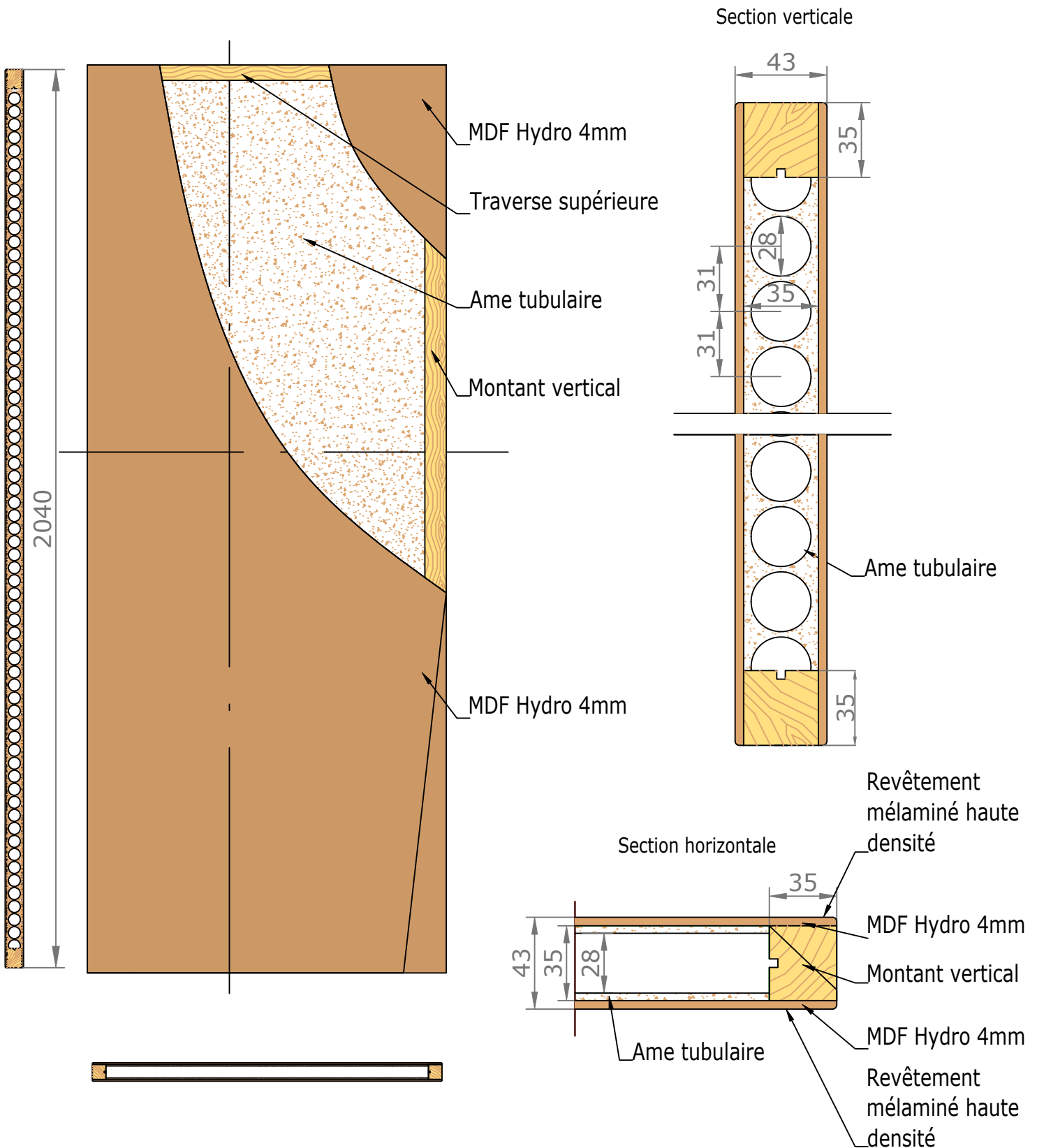

Cadre Renovation et Couvre-Joints (Portes Battantes 1 Vantail)

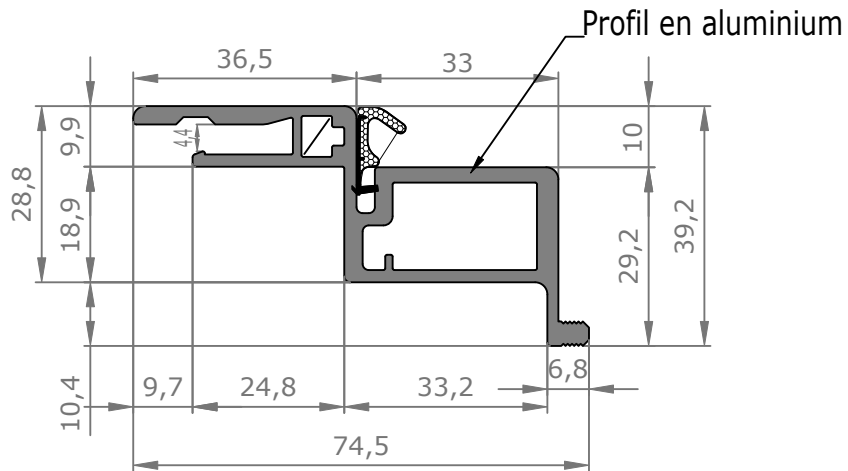

Couvre-Joints 100x15

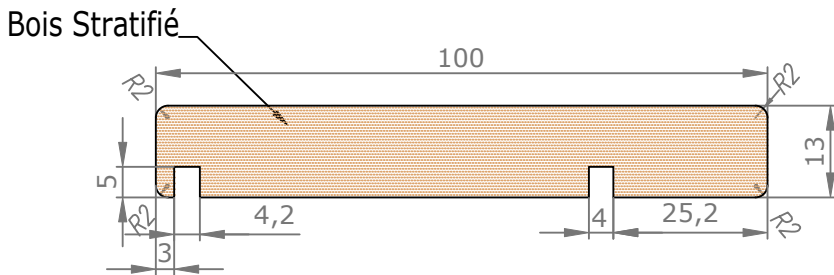

Languette MDF

39x4

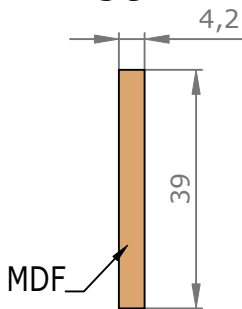

Couvre-Joints 100x55

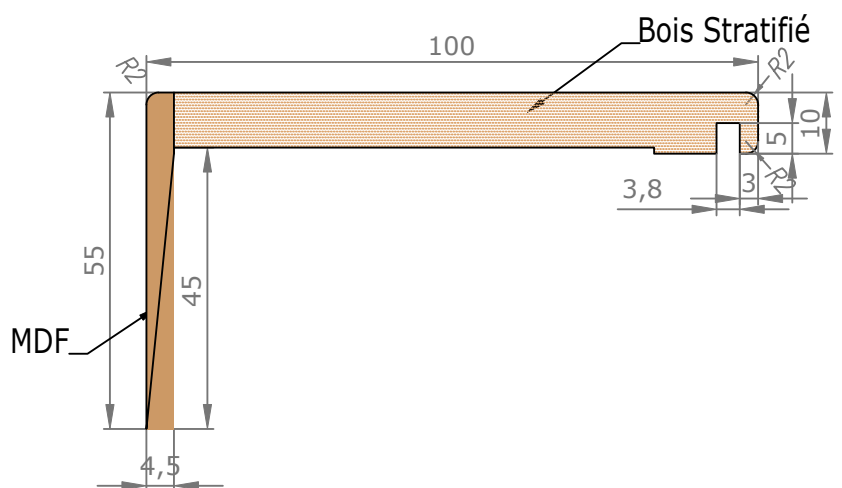

Joint de confort :

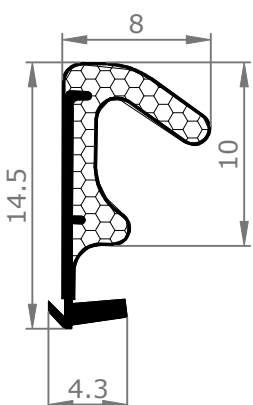

- Blanc ligné = Blanc
- Chêne Cendré brossé = Gris
- Chêne Vicenza = Marron
- Noyer Canaletto = Marron
- Olmo Artico = Blanc
- Olmo Baltico = Gris
- Olmo Deserto = Marron
- Chêne Moka = Marron

Extension

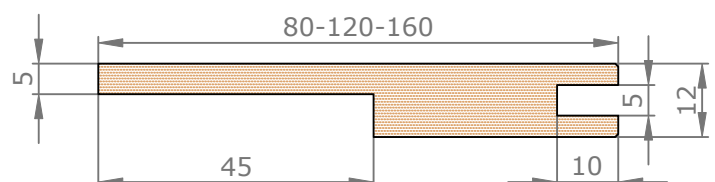

CADRE RENO CHARNIÈRES INVISIBLES COUVRE-JOINTS EXT. SEMI AFFLEURANTS 100X55 INT. 100X15

Passage Nominal 820x2040

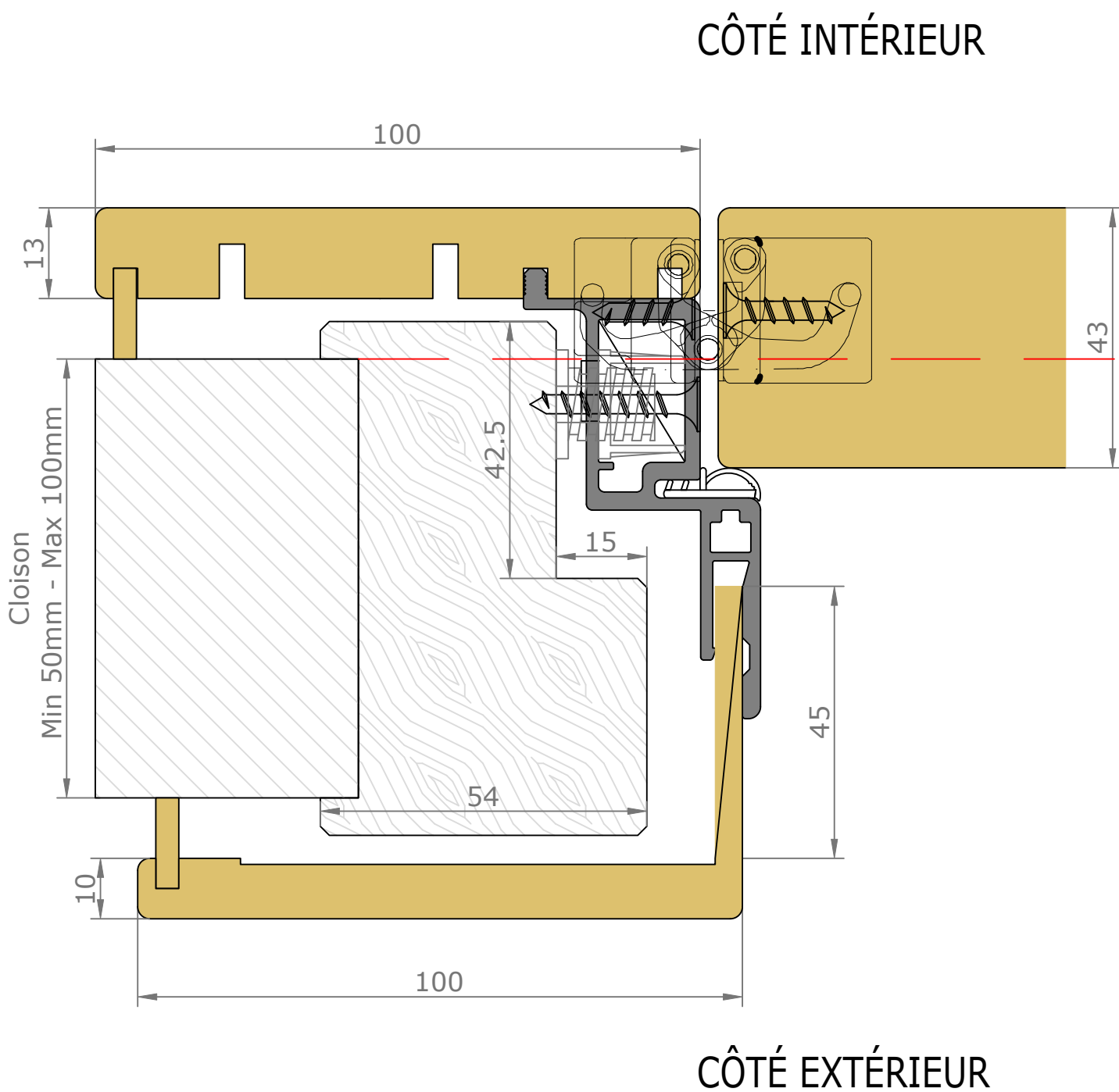

— — : Arrêt de sol conseillé
(au nu du mur extérieur)

Accessoires

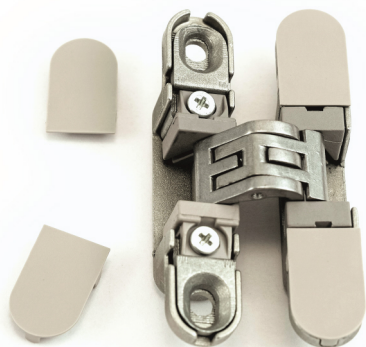

Charnière invisible
Chromé satiné ou noir

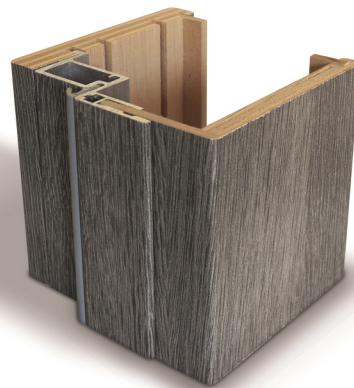

Cadre en aluminium



Serrure à clé L



Serrure à
condamnation



Serrure à clé I
(cylindre européen)